

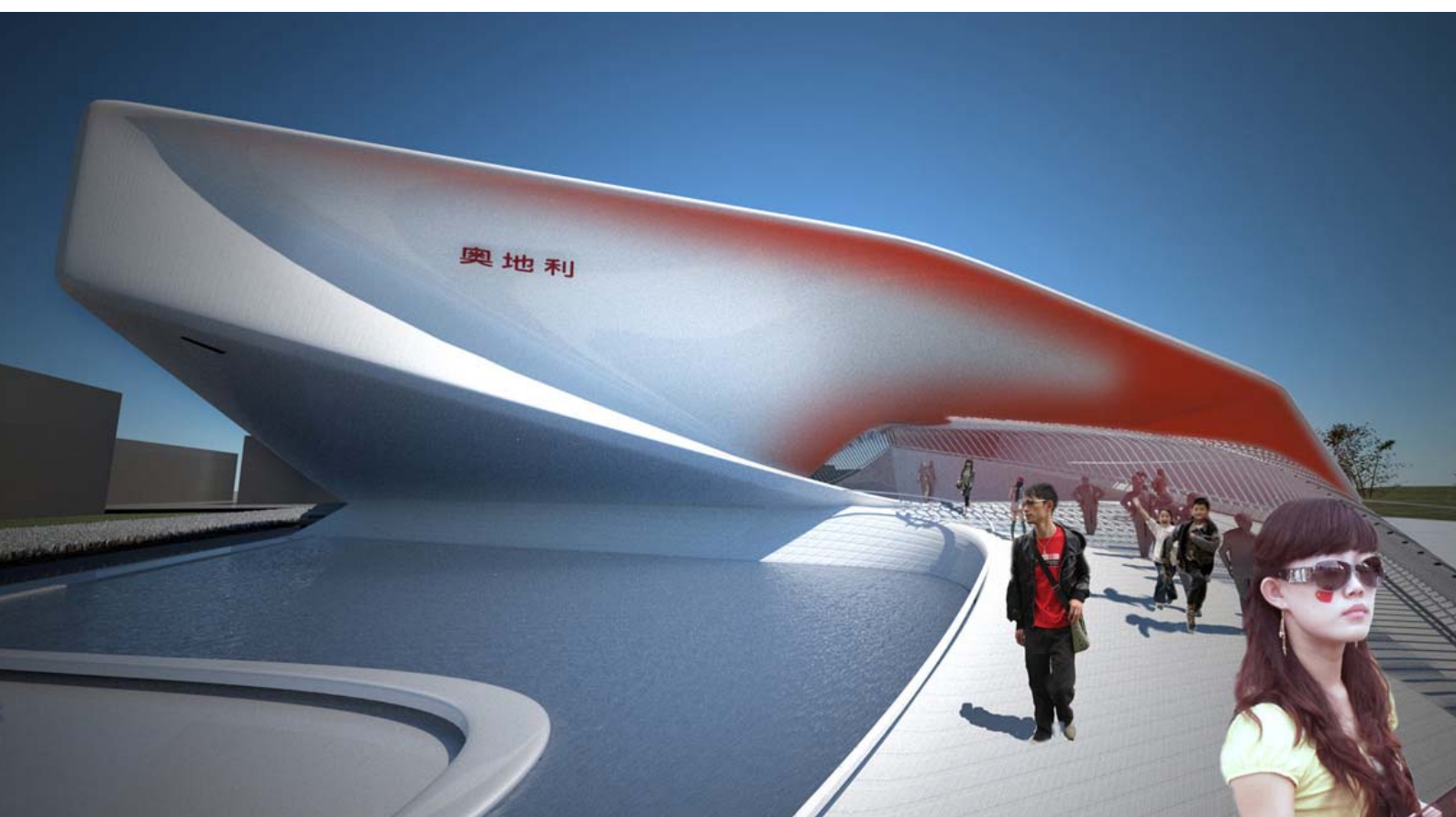

AUSTRIA EXPO SHANGHAI 2010  
2010年上海世博会奥地利馆

## EXPO 2010 Shanghai FACT-Sheet



## Index

<u>1</u>	<u>GENERAL INFORMATION</u>	<u>3</u>
<u>2</u>	<u>THE AUSTRIAN PAVILION</u>	<u>3</u>
<u>3</u>	<u>YOUR PARTICIPATION</u>	<u>4</u>
<u>4</u>	<u>COSTS</u>	<u>5</u>
<u>5</u>	<u>CONTACT DATA</u>	<u>5</u>
<u>6</u>	<u>AUSTRIAN COMPANIES USING THE VIP-LOUNGE</u>	<u>8</u>

1 General Information	
World exposition	EXPO 2010 Shanghai
Theme	Better City, better life
Venue	Shanghai - Pudong and Puxi
Total area	5,28 km <sup>2</sup>
Participants	240 nations, cities and international organizations
Period	May 1st 2010 until October 31st 2010
Opening hours	9:30 to 22:30 Monday to Sunday
Ticket prices	1 day ca. € 16 3 days ca. € 40 7 days ca. € 90 After-work-ticket ca. € 9 Please check the following link for further information: <a href="http://en.expo2010.cn/expotickets/ticketsnews/Price.htm">http://en.expo2010.cn/expotickets/ticketsnews/Price.htm</a>
EXPO store	Flagship Store First floor, 558 Nan Jing Dong Road(Department Store for Travel Products)/南京路558号上海世博馆 Opens 10:00 am - 10:00 pm everyday  Future Shop Sixth floor, 558 Nan Jing Dong Road(Department Store for Travel Products)/南京路558号上海世博馆 Opens 10:00 am - 5:00 pm
2 The Austrian Pavilion	
Subtheme	Austria - Feel the harmony
Position	Stand-Alone Pavilion, Zone C
Concept	Multimedia-based interactive tour through Austria, from the mountains via the forests, through the lake area to the city
Pavilion-Facts	<ul style="list-style-type: none"> <li>• Area 2.000 m<sup>2</sup>, 2 floors</li> <li>• VIP-Lobby: 41 m<sup>2</sup></li> <li>• VIP-Lounge: 244 m<sup>2</sup></li> <li>• Restaurant/Bar: 231 m<sup>2</sup></li> <li>• Outdoor Restaurant area: 145 m<sup>2</sup></li> <li>• Size of the showroom: 638 m<sup>2</sup></li> </ul>

<b>Technical equipment</b>	<ul style="list-style-type: none"> <li>• Interactive presentation wall</li> <li>• DVD-Player</li> <li>• CD-Player</li> <li>• 2 Microphones</li> <li>• Soundsystem for Videobeamer, DVD-Player and CD-Player, MP3-gateway</li> <li>• Loudspeakers</li> <li>• Internet: LAN, WLAN</li> <li>• Dimmable light</li> </ul>
<b>3 Your participation</b>	
<b>Company events</b>	<ul style="list-style-type: none"> <li>• „1 day at EXPO“ as a present for your clients</li> <li>• Conference</li> <li>• Management-meeting</li> <li>• Signing ceremony</li> <li>• Social event with clients, partners and members of staff</li> <li>• Your company as a host at EXPO</li> <li>• ...</li> </ul>
<b>EXPO-Office Austria may help you with...</b>	<ul style="list-style-type: none"> <li>• The following different setups can be organised in the Austrian Pavilion according to your requirements: <ul style="list-style-type: none"> <li>- Conference (ca. 90 pax)</li> <li>- Cocktail (ca. 100 pax)</li> <li>- Lounge (ca. 40 pax)</li> <li>- Dinner (ca. 55 pax)</li> </ul> </li> <li>• Our partner can arrange the necessary setup for the catering of your event: <ul style="list-style-type: none"> <li>- Drinks</li> <li>- Snacks</li> <li>- Buffet</li> <li>- Menu</li> </ul> </li> <li>• The VIP-Team at EXPO is looking forward to welcoming you and your guests.</li> </ul>
<b>Your benefits</b>	<ul style="list-style-type: none"> <li>• Host yours guests within an official Austrian establishment</li> <li>• Public relations and Image-building</li> <li>• Networking in China and internationally</li> </ul>

4 Costs	
<b>Flight Costs *</b>	Economy from € 669,00 p.P. Business from € 2.484,00 p.P.
<b>Hotel Costs*</b>	3-star: ca. € 50,00/ DB 4-star: ca. € 70,00/ DB 5-star: ca. € 100,00/ DB
* EXPO-Office is cooperating with Verkehrsbüro Group and Emirates Airline. Please have a look at their contact data on page 6 for further information. The prices for accommodation are without guarantee. Date: November 2009.	
<b>Hotel recommendations</b>	Crowne Plaza Pudong Shanghai ***** The Portman Ritz-Carlton, Shanghai ***** Equatorial, Shanghai**** We are currently negotiating with further partner hotels
<b>Catering Costs</b>	<ul style="list-style-type: none"> <li>• Cocktail, Canapés: ca. € 20 p.P.</li> <li>• Lunch set menu: from € 10 p.P.</li> <li>• Evening set menu: from € 25 p.P.</li> </ul> Drinks are not included.
<b>Costs for VIP-Lounge Usage</b>	Catering: see above Cleaning: to be defined Further technical equipment: to be defined
5 Contact data	
<b>EXPO Office AUSTRIA</b>	EXPO Office Austria Reitschulgasse 2-3, A 1010 Vienna E: <a href="mailto:office@expoaustria.at">office@expoaustria.at</a> T: +43 1 532 18 11-0 F: +43 1 532 18 11-14 W: <a href="http://www.expoaustria.at">www.expoaustria.at</a>  EXPO Office Austria in Shanghai Austrian Consulate General - Section EXPO 2010 Suite 506B, Shanghai Center, 1376 Nanjing Xi Lu Shanghai 200040, PRC  E: <a href="mailto:office.shanghai@expoaustria.at">office.shanghai@expoaustria.at</a> T: +86 21 62798208

<p><b>Cooperation travel agency</b></p>	<p>VERKEHRSBÜRO GROUP  Verkehrsbüro Ruefa Reisen GmbH  <b>Christof Vojtechovsky</b>  Product Manager Incentives and special groups (K 20250)  Dresdner Straße 81-85, 3rd floor, no. 309, A 1200 Vienna  E: christof.vojtechovsky@verkehrsbuero.at  T: +43/1/588 00-112   F: +43/1/588 00-133  W: <a href="http://www.verkehrsbuero.at">www.verkehrsbuero.at</a></p> <p>Verkehrsbüro would be happy to arrange your journey to Shanghai - flights, Visa, hotel room, tickets for the EXPO, guided tours and trips to other destinations in China (min. 2 persons).</p>
<p><b>Cooperation Airline</b></p>	<p>EMIRATES AIRLINES  <b>Robert Posch</b>  Sales Executive Austria &amp; Slovakia  Mahlerstrasse 12/Stg. 6, A 1010 Wien  E: robert.posch@emirates.com  T: +43 532 6028 104   F: +43 1 533 68 87  W: <a href="http://www.emirates.at">www.emirates.at</a></p>
<p><b>Consulate General</b></p>	<p><b>Austrian Consulate General Shanghai</b>  Heinz Michael  Consul General  Qi Hua Tower, 3rd floor No. 3A  1375 Huai Hai Road, Shanghai 200031 PRC  T: +86/21/647 40 268  E: shanghai-gk@bmeia.gv.at  W: <a href="http://www.aussenministerium.at/shanghai">www.aussenministerium.at/shanghai</a></p>
<p><b>Austrian Consulate General - Commercial Section</b></p>	<p><b>Austrian Consulate General - Commercial Section</b>  Raymundt Gradt  Commissioner General  Suite 514, P.O.Box 155, 1376 Nanjing Xi Lu  200040 Shanghai, P.R. CHINA  T +86-21-62 79 71 97  E: <a href="mailto:shanghai@wko.at">shanghai@wko.at</a></p>

**Consulate P.R. China /  
Visa**

**Consulate P.R. China / Visa**

Neulinggasse 29/1/11, A 1030 Wien

Opening hours:

Mo, We: 08:30 to 11:00; 14:00 to 17:00

Fr: 08:30 to 11:00

T: +43 1 7103648

Information by phone:

Tu: 09:00 to 11:30; 14:30 to 17:00

Th: 09:00 to 11:30; 14:30 to 17:00

T: +43 1 710364816

## 6 Austrian Companies using the VIP-Lounge

### Alternative A

You are not yet making business in China but would like to enter the market? Use the VIP-Lounge at EXPO to establish contacts.

The Austrian Embassy Commercial Section Shanghai would be happy to help you clarifying the possibilities for your business in China and getting in contact with Chinese companies and organizations. Please talk to Mr. Gradt and his team directly via the contact data stated above.

### Alternative B

Your company already cooperates with clients and contacts in China. Take the opportunity offered by EXPO Office Austria to invite business partners, authority contacts, multiplying contacts and staff. You can present your company at an elegant cocktail event with a following lunch or evening reception.

One day at EXPO could be set up like this:

- 9.00 get-together for all participants at a Hotel near the EXPO, thereafter transfer to EXPO-area
- 10.00 presentation of your company in the Austrian Pavilion
- 11.00 to 16.00 unguided visit of the EXPO area
- 16.00 presentation of your company part II
- 17.00 cocktail
- 18.30 dinner

Our team is looking forward to helping you to organize your event.



**EXPO Office Austria in Vienna**  
Reitschulgasse 2-3 1010 Vienna  
T. +43 1 532 18 11 0  
F. +43 1 532 18 11-14  
E. [office@expoaustria.at](mailto:office@expoaustria.at)  
URL: [www.expoaustria.at](http://www.expoaustria.at)

**EXPO Office Austria in Shanghai**  
Austrian Consulate General - Section EXPO 2010  
Suite 506B, Shanghai Center, 1376 Nanjing Xi Lu  
Shanghai 200040, PRC  
T. +86 21 62798208  
E. [office.shanghai@expoaustria.at](mailto:office.shanghai@expoaustria.at)  
URL: [www.expoaustria.at](http://www.expoaustria.at)

